

£2,700 Per month
Bridgewood Road

Worcester Park, KT4 8XS

Approximate Gross Internal Area 1506 sq ft - 140 sq m

Ground Floor Area 664 sq ft – 62 sq m

First Floor Area 457 sq ft – 42 sq m

Second Floor Area 385 sq ft – 36 sq m

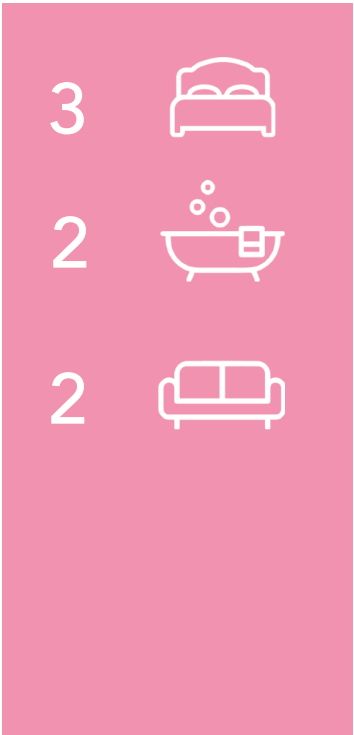
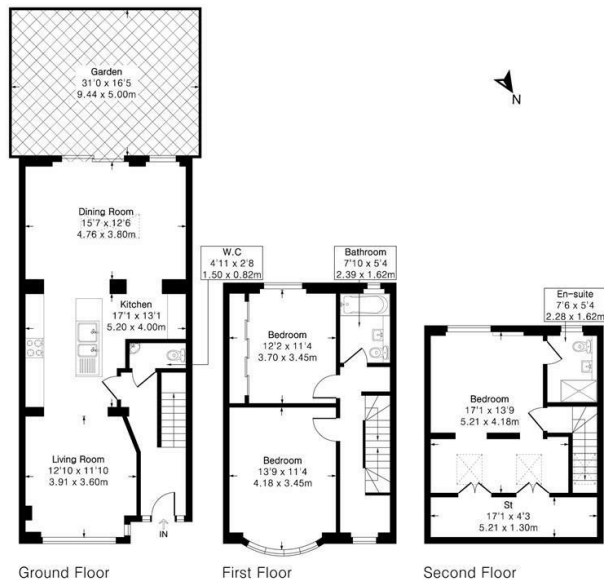

Floor plan produced in accordance with RICS Property Measurement 2nd Edition. Although Pink Plan Ltd ensures the highest level of accuracy, measurements of doors, windows and rooms are approximate and no responsibility is taken for error, omission or misstatement. These plans are for representation purposes only and no guarantee is given on the total square footage of the property within this plan. The figure icon is for initial guidance only and should not be relied on as a basis of valuation.



Energy Efficiency Rating		Current	Potential
Very energy efficient - lower running costs			
(92 plus) A			
(81-91) B			
(69-80) C			
(55-68) D			
(39-54) E		56	
(21-38) F			
(1-20) G			
Not energy efficient - higher running costs			
England & Wales		EU Directive 2002/91/EC	

Agents Note: Whilst every care has been taken to prepare these particulars, they are for guidance purposes only. All measurements are approximate and are for general guidance purposes only and whilst every care has been taken to ensure their accuracy, they should not be relied upon and potential buyers/tenants are advised to recheck the measurements



OFFICE ADDRESS

18 Sutton Plaza
Sutton
Surrey
SM1 4FS

OFFICE DETAILS

020 39 170 160
lettings@butlershomes.co.uk
butlershomes.co.uk